

Electromagnetic circular drive

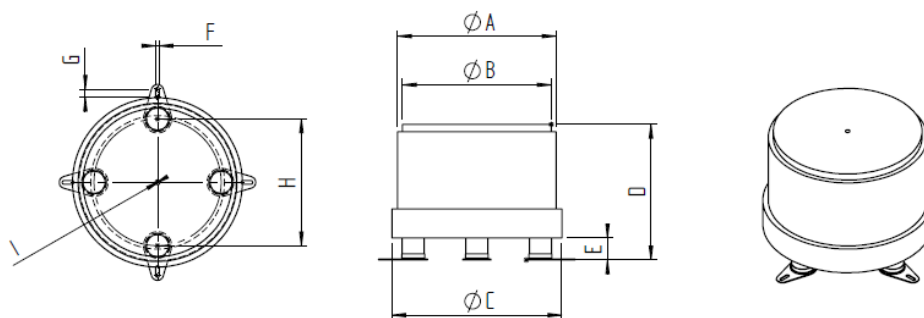

Dimensions:

Drive	Ø A	Ø B	Ø C	D	E	F	G	H	Ø I
150	157	148,5	177	166	25	4,5	9	115	M6x1
200	188	177,5	220	195	30	6	9	160	M8x1,25
300	287	269	307	246	40	6,3	15	230	M12x1,75
400	381	368	397	272	40	6,3	15	310	M12,75
450	381	368	397	309	42	6,3	15	310	M12x75
550	505	490	545	363	55	10,5	10	400	M12x1,75

Technical parametres:

Drive	Input voltage (V)	Input frequency (Hz)	Power (W)	Weight of drive (Kg)	Top bowl applicable diameter (mm)	Load capacity (Kg)	Orientation capacity
150	220/110	50/60	100	9,4	Ø 250	4	Left/right
200	220/110	50/60	150	16,2	Ø 300	7	Left/right
300	220/110	50/60	250	34,7	Ø 440	14	Left/right
400	220/110	50/60	350	54,7	Ø 620	25	Left/right
450	220/110	50/60	500	64,7	Ø 800	33	Left/right
550	220/110	50/60	1000	200	Ø 1000	40	Left/right